

Stampante - Printer

STUDIO JET 300

CATALOGO PARTI DI RICAMBIO SPARE PARTS CATALOGUE

Code 687040A-00

IMPORTANTE

PUBBLICAZIONE REDATTA DA OLIVETTI LEXIKON (GESTIONE RICAMBI E SCORTE).
QUESTO CATALOGO È L' UNICO DOCUMENTO AL QUALE FARE RIFERIMENTO PER
ORDINARE LE PARTI DI RICAMBIO.

IMPORTANT

THIS PUBLICATION IS WRITTEN BY OLIVETTI LEXIKON (SPARE PARTS DEPARTMENT).
THIS CATALOGUE IS THE ONLY DOCUMENT TO WHICH REFERENCE MAY BE MADE
FOR ORDERING SPARE PARTS.

**PUBBLICAZIONE EMESSA DA:
PUBLICATION ISSUED BY:**

Olivetti Lexikon, S.p.A.

Documentazione

77, Via Jervis - 10015 Ivrea (Italy)

Copyright © 1999, by Olivetti

All rights reserved

Printed in Italy by:

STUDIOJET 300

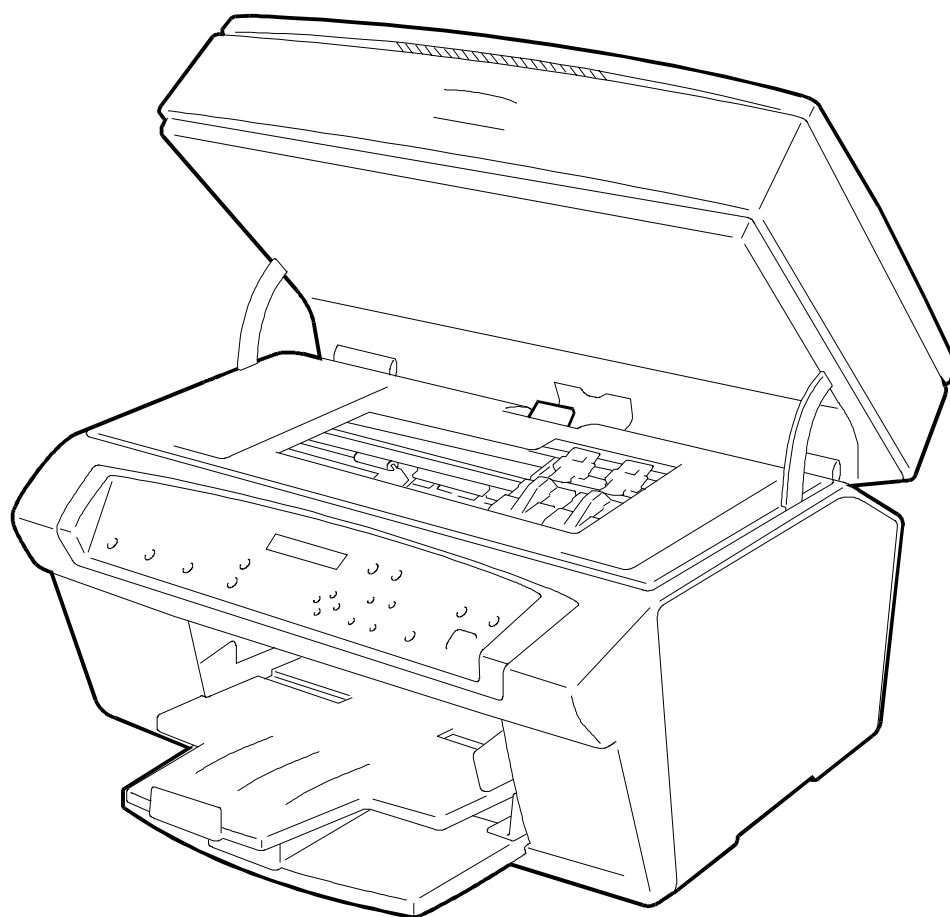

INDICE

GRUPPO CARROZZERIA 1	Pag.	3
GRUPPO CARROZZERIA 2	"	4
GRUPPO CARROZZERIA 3	"	5
GRUPPO CARROZZERIA 4	"	6
GRUPPO CARROZZERIA 5	"	7
GRUPPO CARROZZERIA 6	"	8
FONDELLO STAMPANTE	"	9
GRUPPO SCANNER	"	10
GRUPPO CARRELLO SCANNER	"	11
PIASTRA SCANNER	"	12
GRUPPO STAMPA	"	13
GRUPPO PIASTRA CARRELLO	"	14
GRUPPO CARTA	"	15
GRUPPO RULLINI INGRESSO	"	16
GRUPPO ESPULSIONE	"	17
GRUPPO RULLO TRASCINAMENTO (CASSETTO 1)	"	18
GRUPPO TRASCINAMENTO CARTA (CASSETTO 1)	"	19
GRUPPO TRASCINAMENTO CARTA	"	20
GRUPPO SERVIZI	"	21
GRUPPO AVANZAMENTO CARTA	"	22
INDICE GENERALE DEI CODICI	"	23

INDEX

CASING ASSEMBLY 1	Pag.	3
CASING ASSEMBLY 2	"	4
CASING ASSEMBLY 3	"	5
CASING ASSEMBLY 4	"	6
CASING ASSEMBLY 5	"	7
CASING ASSEMBLY 6	"	8
PRINTER BASE	"	9
SCANNER ASSEMBLY	"	10
SCANNER CARRIAGE ASSEMBLY	"	11
SCANNER PWBA	"	12
PRINT ASSEMBLY	"	13
CARRIAGE BOARD ASSEMBLY	"	14
PAPER ASSEMBLY	"	15
ENTRY ROLLERS ASSEMBLY	"	16
EJECTING ASSEMBLY	"	17
FEED ROLLER ASSEMBLY (CASSETTE 1)	"	18
PAPER FEED ASSEMBLY (CASSETTE 1)	"	19
PAPER FEED ASSEMBLY	"	20
SERVICE ASSEMBLY	"	21
PAPER ADVANCEMENT ASSEMBLY	"	22
GENERAL CODES INDEX	"	23

GRUPPO CARROZZERIA 1

CASING ASSEMBLY 1

STUDIOJET 300

REF.	CODE	DESCRIZIONE	DESCRIPTION
1	290641 K	CERNIERA SCANNER	SCANNER HINGE
2	290740 S	COPERTURA CON LOGO	COVER WIT LOGOTIPO
3	204172 B	GRUPPO CONSOLE	CONSOLE ASSEMBLY
4	204171 A	SCocca SCANNER	SCANNER CASING
5	290741 P	TAPPO VITE SCANNER	SCANNER SCREW COVER
6	290626 C	COPERCHIO SCANNER	SCANNER COVER

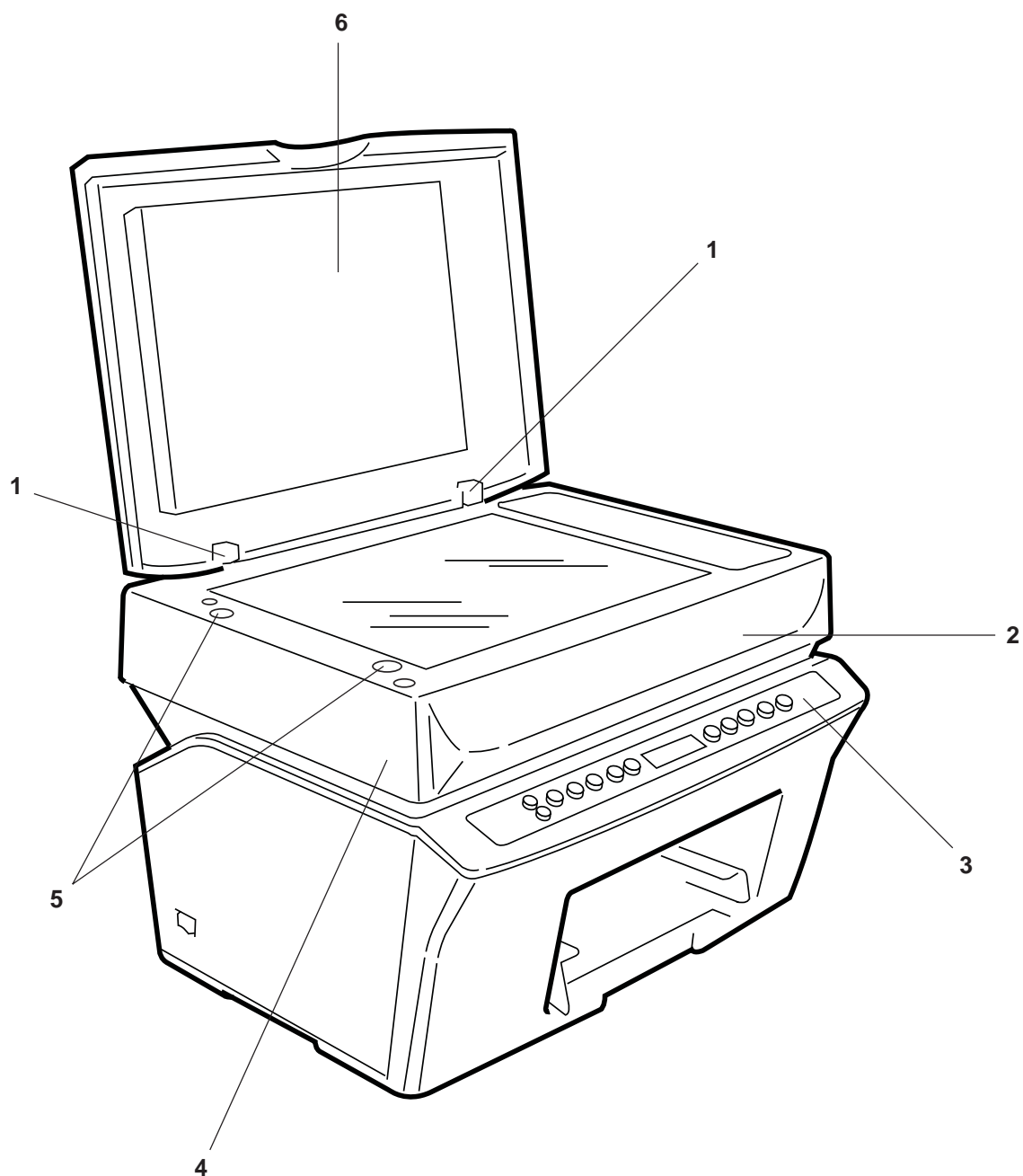

REF.	CODE	DESCRIZIONE	DESCRIPTION
1	204170 M	GRUPPO SCANNER	SCANNER ASSEMBLY
2	290311 G	CASSETTO USCITA	TRAY EXIT
3	290358 X	ESTENSIONE PER RACCOGLITORE	EXTENSION - UPPER CASSETTE
4	290318 P	ESTENSIONE PER CASSETTO	EXTENSION - LOWER CASSETTE
5	290305 K	CASSETTO INGRESSO	TRAY INPUT

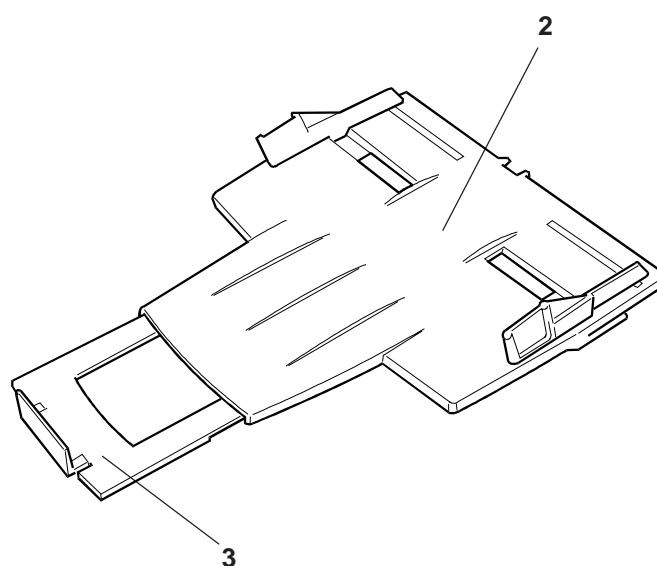
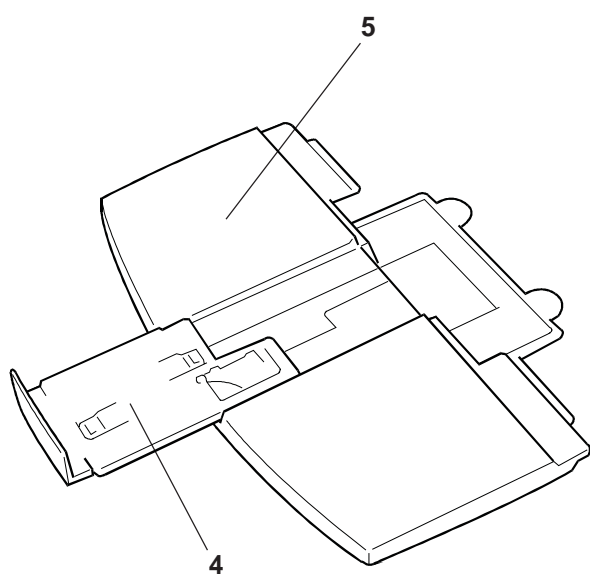
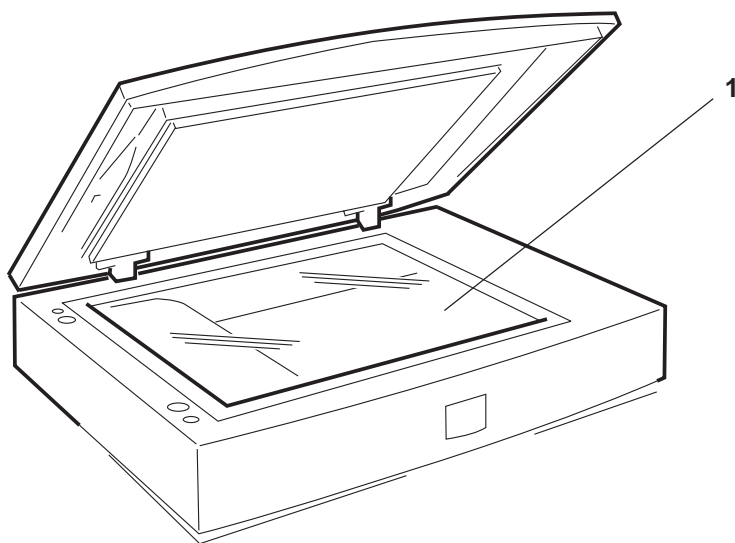

REF.	CODE	DESCRIZIONE	DESCRIPTION
1	290638 Q	COPERTURA POSTERIORE	REAR COVER

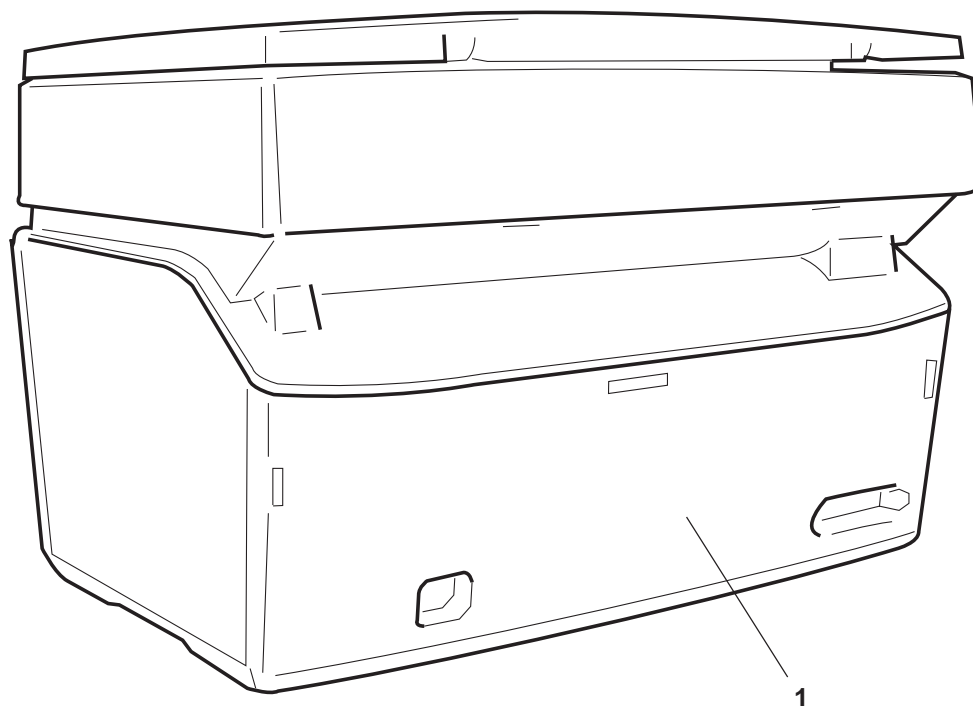

REF.	CODE	DESCRIZIONE	DESCRIPTION
1	290497 U	PIEDINO SCANNER	SCANNER FOOT
2	290640 W	FONDELLO SCANNER	SCANNER BASE
3	204172 B	GRUPPO CONSOLE	CONSOLE ASSEMBLY
4	290498 D	PIEDINO BASE	BASE FOOT
5	290511 Z	PIASTRINO PER MAGNETE	PLATE FOR MAGNET

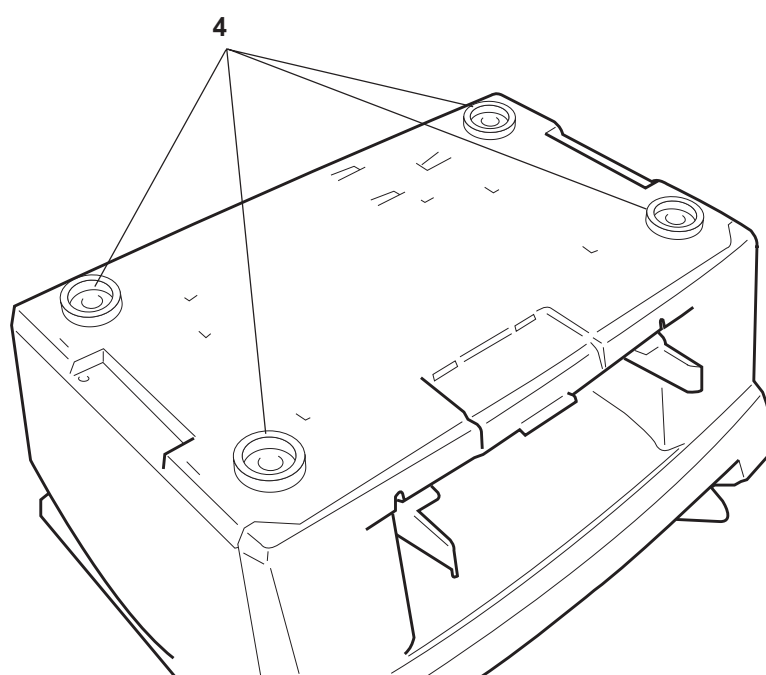
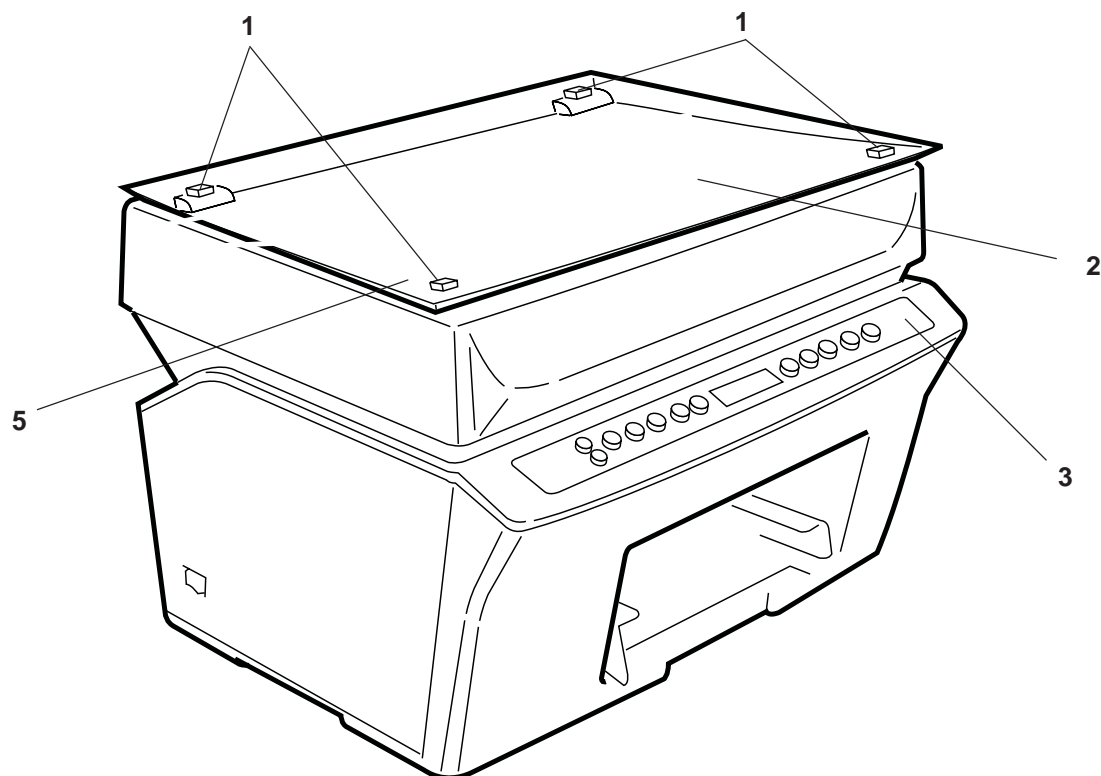

REF.	CODE	DESCRIZIONE	DESCRIPTION
1	290628 N	PANNELLO ANTERIORE	FRONT COVER
2	290637 F	FIANCO DESTRO	COVER - RIGHT SIDE
3	204071 H	BRACCIO DESTRO	ARM BRAKE RIGHT
4	290639 R	PANNELLO SUPERIORE	COVER ASSY - PRINTER TOP
5	204070 L	BRACCIO SINISTRO	ARM BRAKE LEFT
6	290636 E	FIANCO SINISTRO	COVER - LEFT SIDE

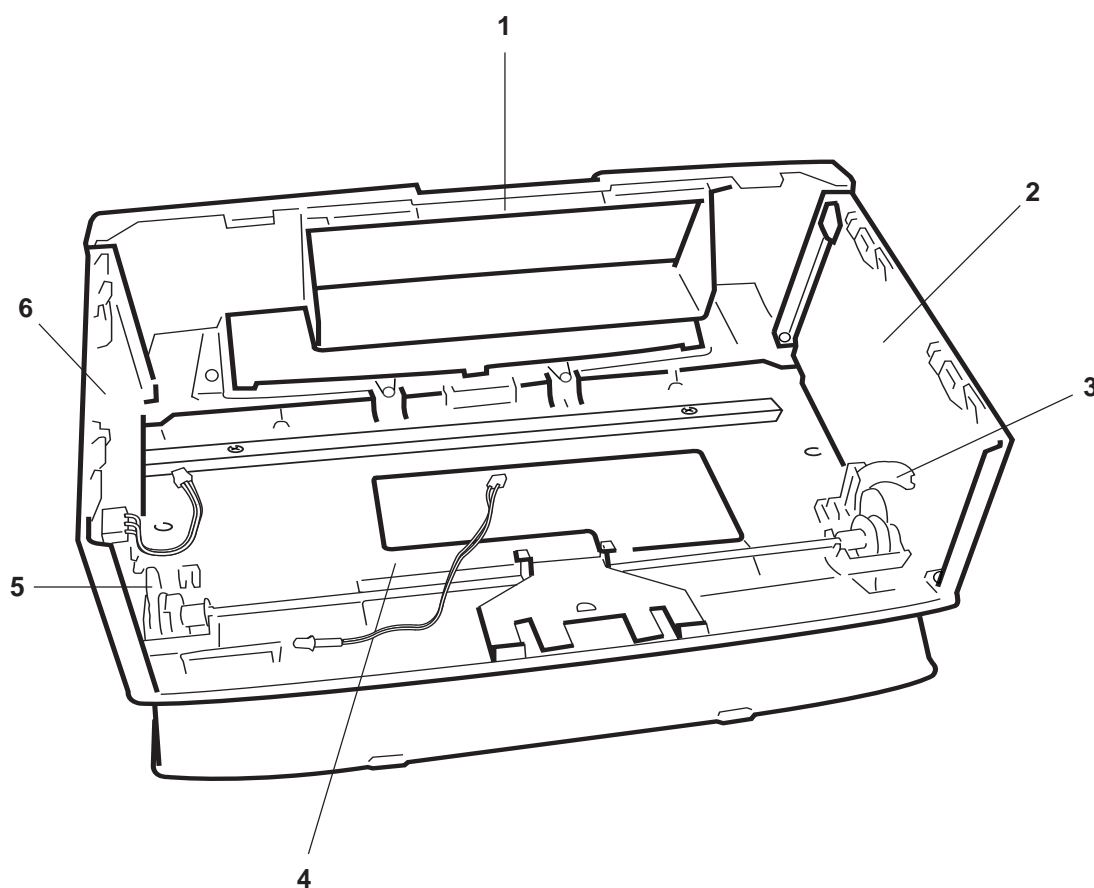

REF.	CODE	DESCRIZIONE	DESCRIPTION
1	204106 A	GRUPPO INTERRUETTORE	SWITCH MAIN
2	204125 U	CAVO COLLEGAM. SCANNER-STAMPANTE	WIRE ASSY - SCANNER TO PRINTER

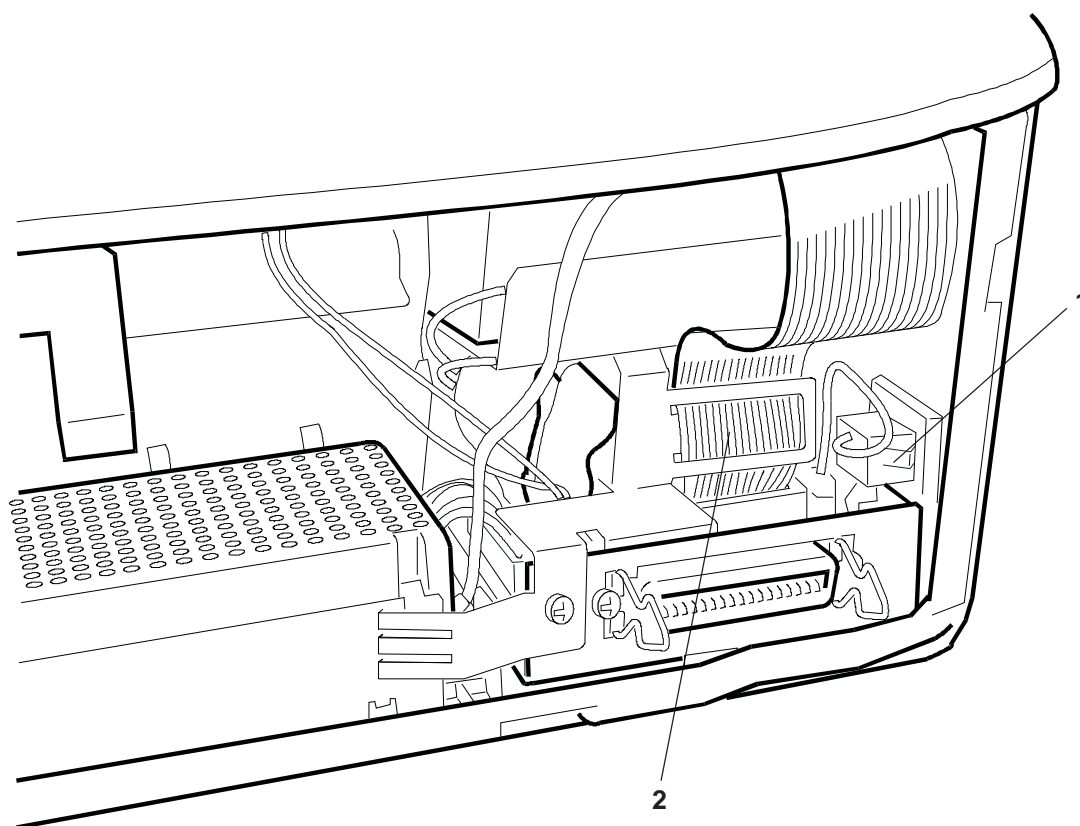

FONDELLO STAMPANTE PRINTER BASE

STUDIOJET 300

REF.	CODE	DESCRIZIONE	DESCRIPTION
1	204140 P	GRUPPO ALIMENTATORE	POWER SUPPLY ASSY
2	204148 K	PIASTRA BASE	PWBA - MAIN
3	290635 D	FONDELLO	COVER ASSY - PRINTER BASE
4	280634 A	FUSIBILE 2,5 A.	2.5 A FUSE

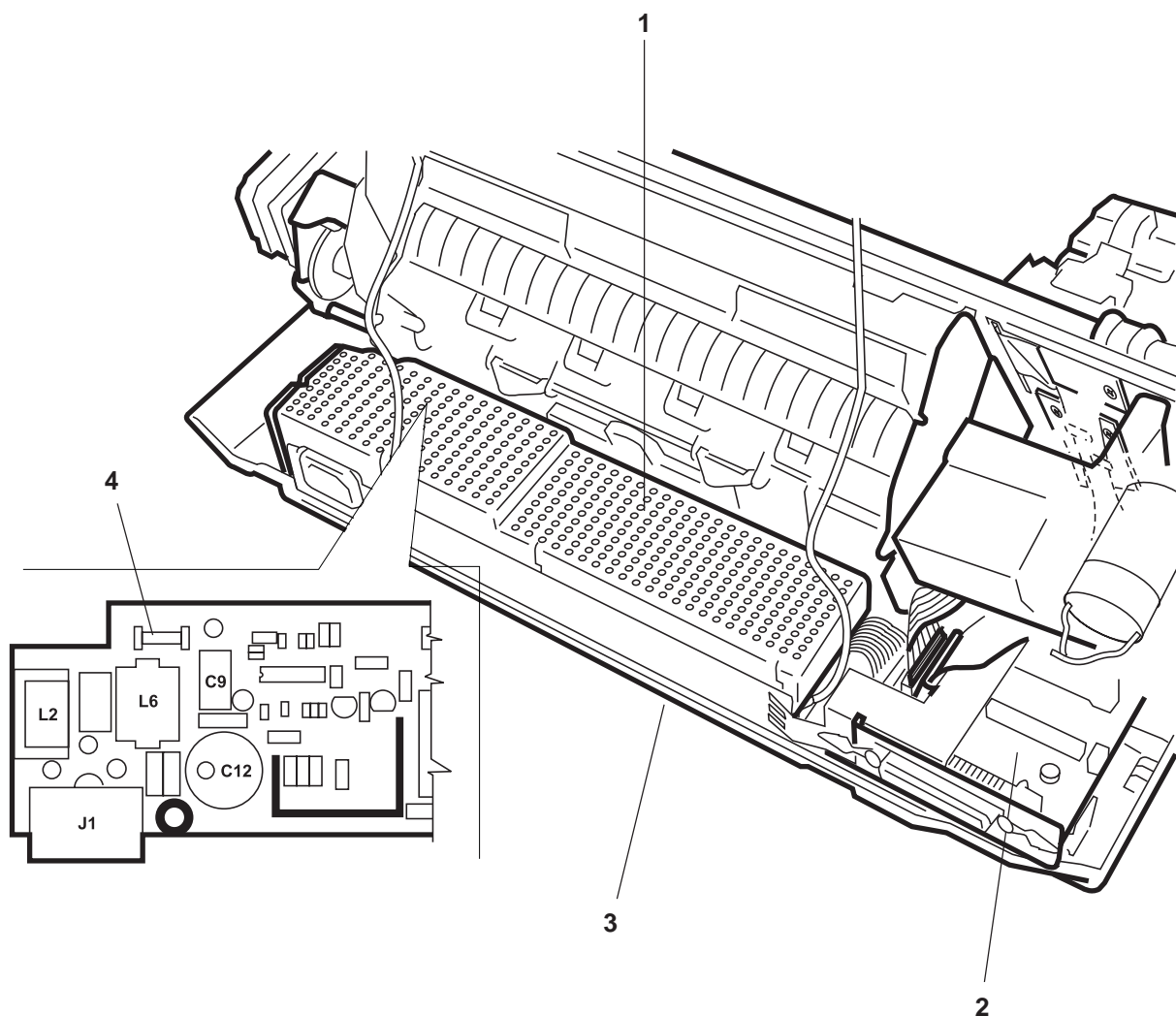

GRUPPO SCANNER SCANNER ASSEMBLY

STUDIOJET 300

REF.	CODE	DESCRIZIONE	DESCRIPTION
1	204126 V	CAVO COLLEGAMENTO SCANNER	WIRE ASSY - SCANNER VIDEO
2	204132 T	GRUPPO MOTORE SCANNER	MOTOR ASSY - SCANNER
3	204133 U	CINGHIA DENTATA SCANNER	BELT - SCAN CARRIAGE

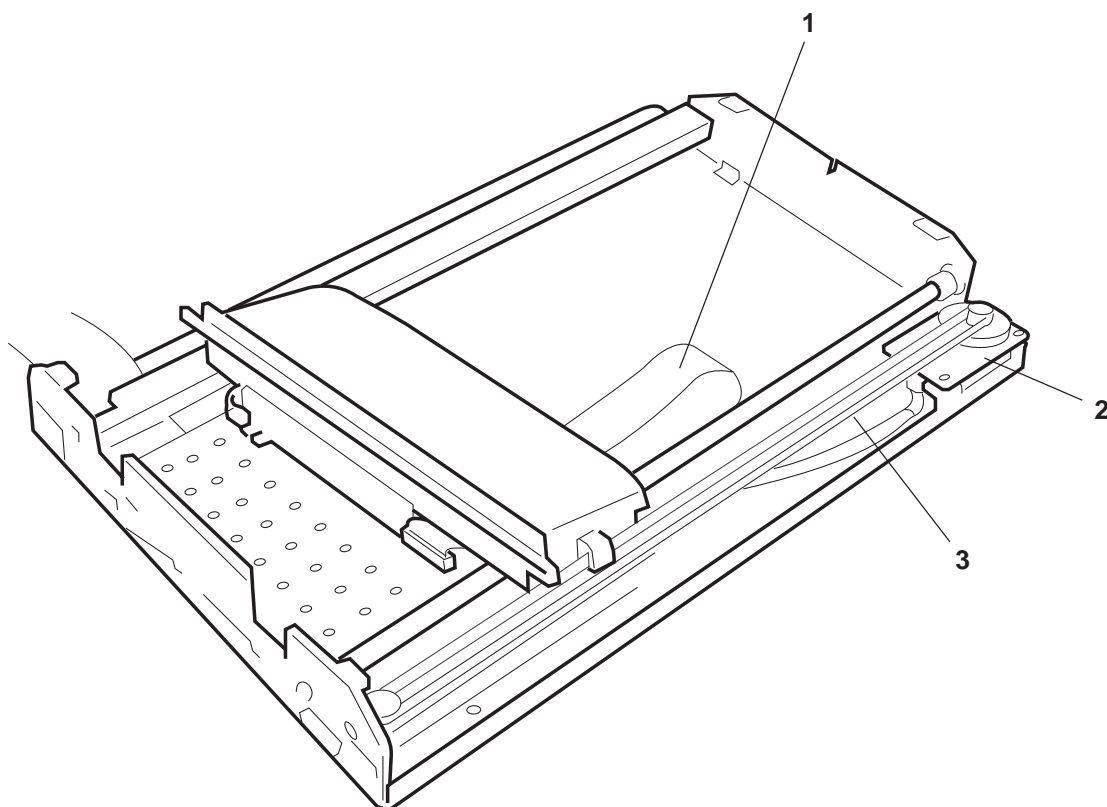

GR. CARRELLO SCANNER SCANNER CARRIAGE ASSEMBLY

STUDIOJET 300

REF.	CODE	DESCRIZIONE	DESCRIPTION
1	204128 F	LAMPADA SCANNER	LAMP DOCUMENT
2	204129 G	PIASTRA CCD	PWBA - CCD
3	204130 D	ALIMENTATORE LAMPADA	POWER SUPPLY - LAMP

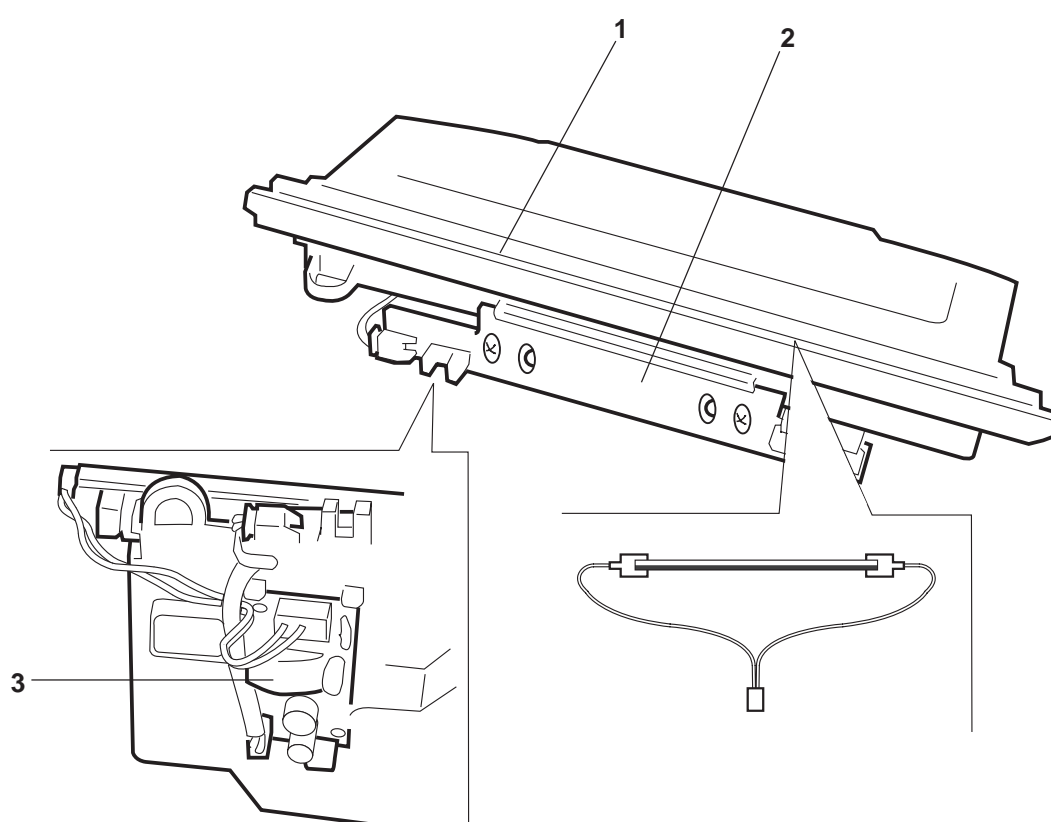

REF.	CODE	DESCRIZIONE	DESCRIPTION
1	204131 S	PIASTRA SCANNER	PWBA - SCANNER

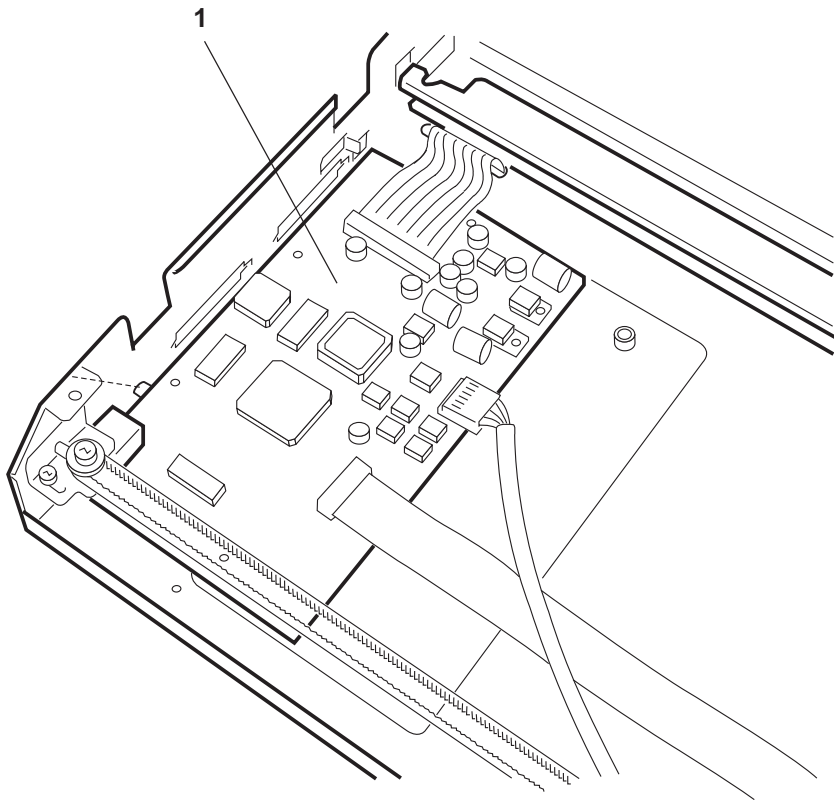

REF.	CODE	DESCRIZIONE	DESCRIPTION
1	290474 C	GR. TENDICINGHIA	BELT TENSION ASSEMBLY
2	290245 N	FILM ENCODER	ENCODER BLADE
3	290706 M	CARRELLO CON BOCCOLE	CARRIAGE WITH BUSHING
4	290235 C	PULITORE TESTINA	HEAD CLEANER
5	290239 Q	TAPPO PER TESTINA	CAP FOR HEAD
6	290236 D	MOLLA SUPPORTO TERGITESTINA	HEAD CLEANER SUPPORT SPRING
7	290268 V	GR. STAZIONE DI SERVIZIO	SERVICE STATION ASSEMBLY
8	290241 J	MOLLA RECUPERO SLITTA	SLIDE RECOVERY SPRING
9	290227 C	BALESTRA ENCODER	ENCODER LEAF SPRING
10	290283 D	GR. MOTORE CARRELLO	CARRIAGE MOTOR ASSEMBLY
11	290214 F	MOLLA BLOCCAGGIO TESTINA	HEAD BLOCKING SPRING
12	290212 D	LEVA BLOCCAGGIO TESTINA	HEAD BLOCKING LEVER

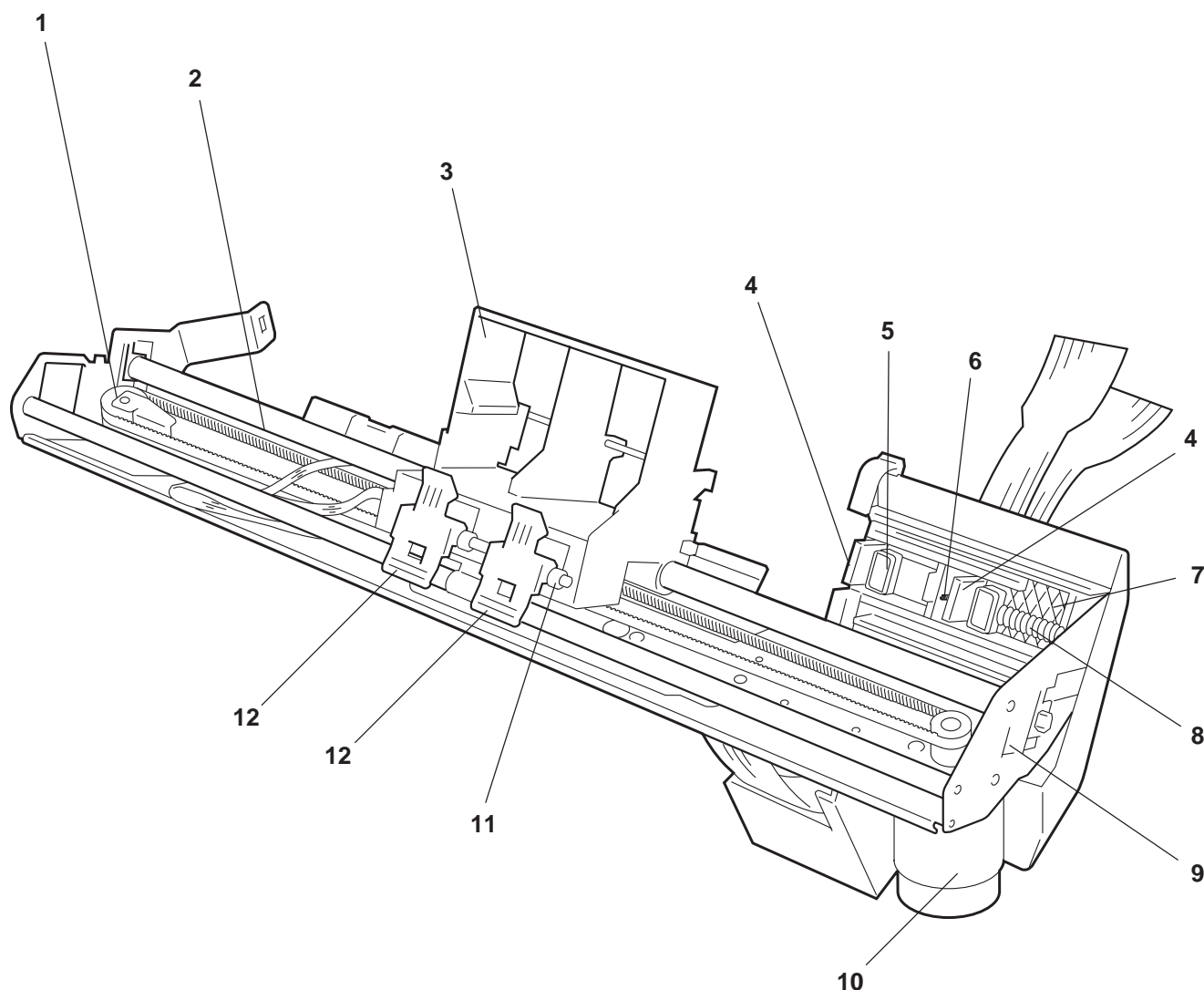

GRUPPO PIASTRA CARRELLO
CARRIAGE BOARD ASSEMBLY

STUDIOJET 300

REF.	CODE	DESCRIZIONE	DESCRIPTION
1	290211 C	GR. ELETTRONICO CARRELLO	CARRIAGE ELECTRONICS ASSEMBLY

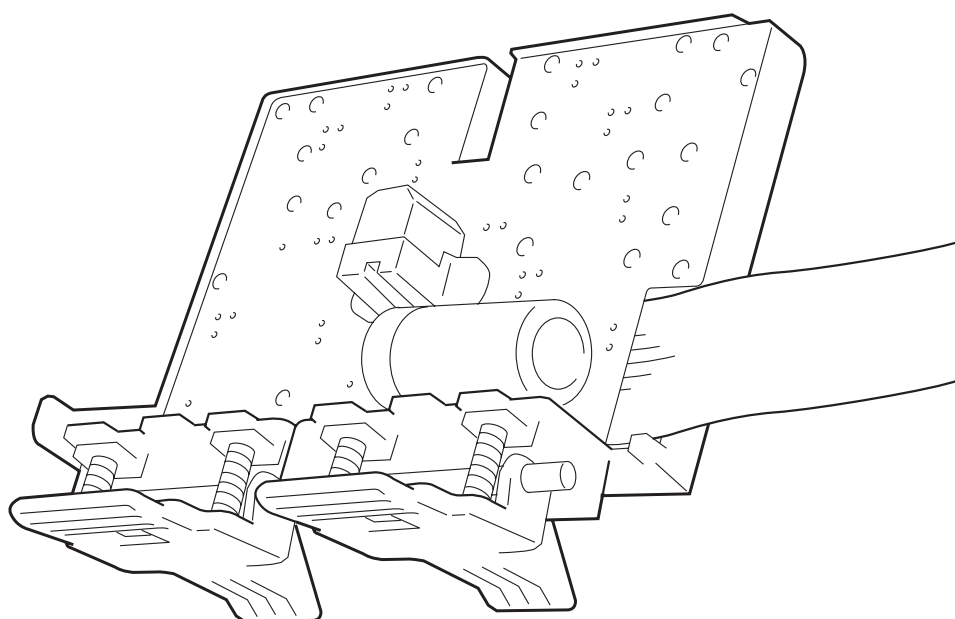

REF.	CODE	DESCRIZIONE	DESCRIPTION
1	290242 K	GR. RACCOGLITORE INCHIOSTRO	INK PICKER ASSEMBLY
2	290225 A	RULLINO PER TEGOLO	ROLLER FOR PAPER GUIDE
3	290226 B	MOLLA PER TEGOLO	SPRING FOR PAPER GUIDE
4	290220 R	MOLLA PER TENDICINGHIA	SPRING FOR BELT TENSION
5	290249 S	GR. TEGOLO LATERALE	SIDE PAPER GUIDE ASSEMBLY
6	290252 M	GR. TEGOLO CENTRALE	CENTRAL PAPER GUIDE ASSEMBLY

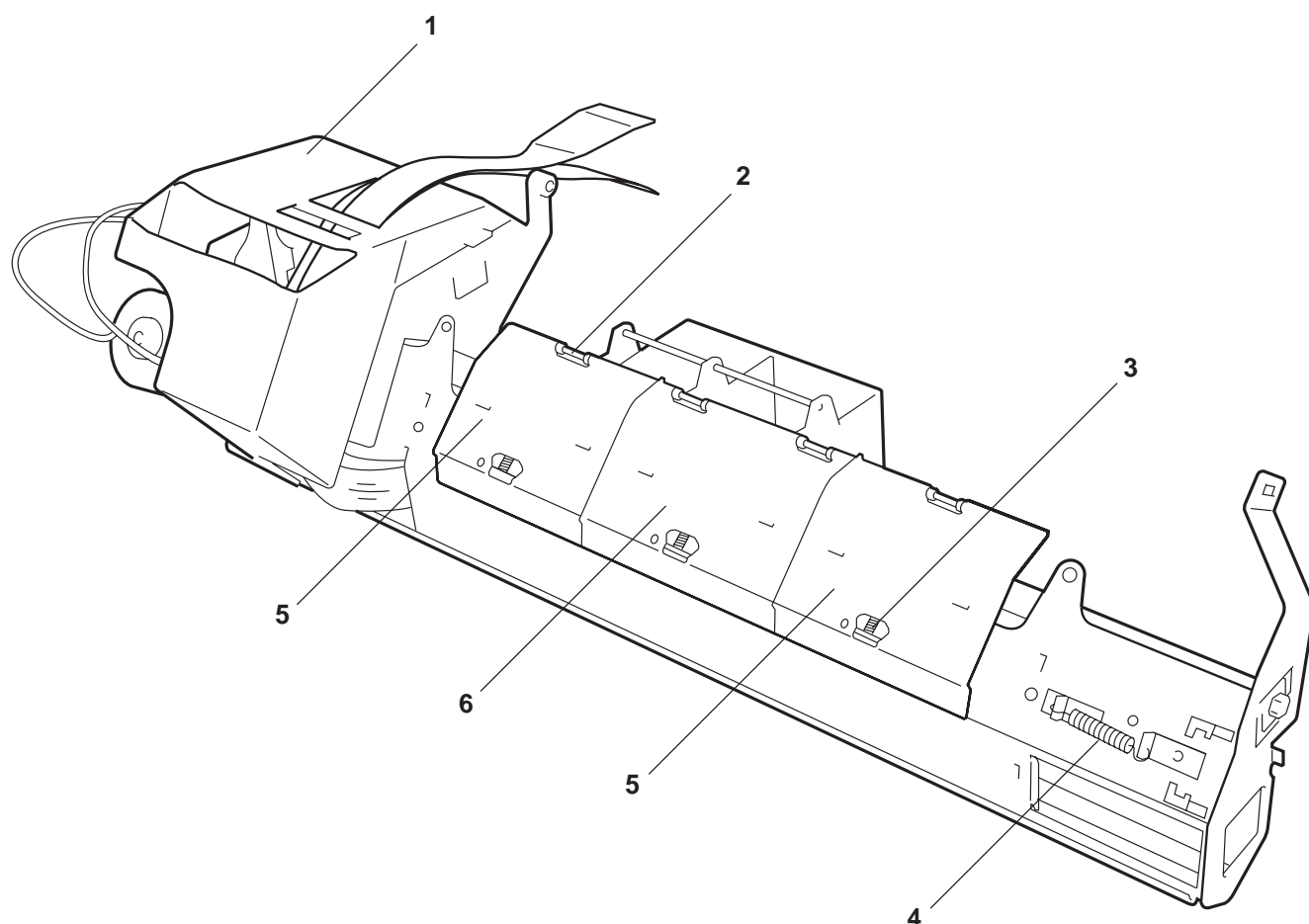

GRUPPO RULLINI INGRESSO
ENTRY ROLLERS ASSEMBLY

STUDIOJET 300

REF.	CODE	DESCRIZIONE	DESCRIPTION
1	290480 F	GR. RULLINI INGRESSO	ENTRY ROLLERS ASSEMBLY

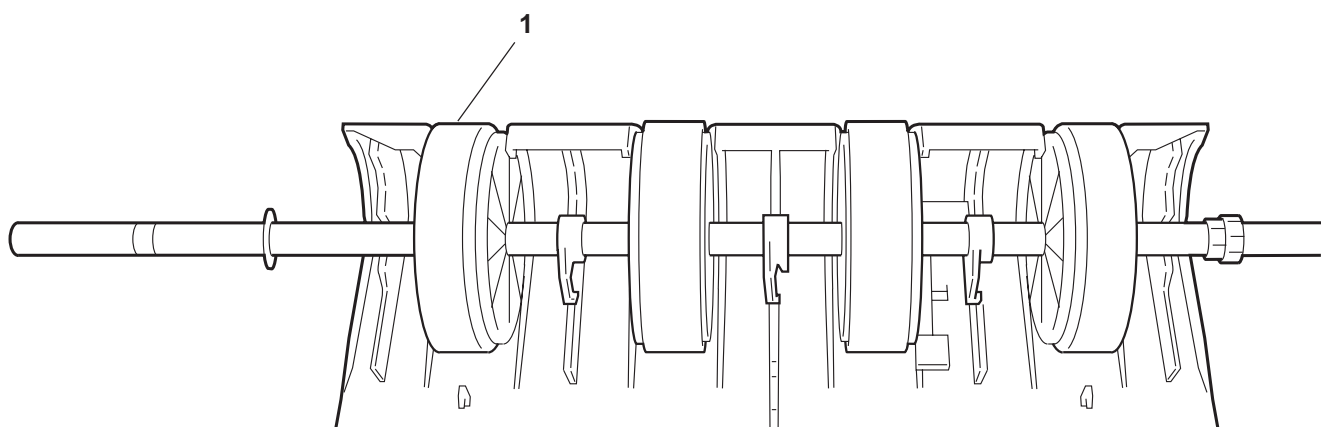

GRUPPO ESPULSIONE EJECTING ASSEMBLY

STUDIOJET 300

REF.	CODE	DESCRIZIONE	DESCRIPTION
1	290125 W	GRUPPO FOTO MONTATO	PHOTO ASSEMBLY
2	290096 V	CONTENITORE CARTA	PAPER CASE
3	290136 Z	BANDELLA RICHIAMO CARTA	PAPER RETURN STRIP
4	290126 X	MOLLA	SPRING
5	290070 N	BOCCOLA	BUSHING
6	290099 G	GRUPPO RULLINI ESPULSORI	EJECTOR ROLLERS ASSEMBLY
7	290481 U	GRUPPO A PICCHI	TOOTHED ASSEMBLY
8	290098 F	INGRANAGGIO COMANDO RULLINI ESPULS.	EJECTOR ROLLERS COMMAND GEAR

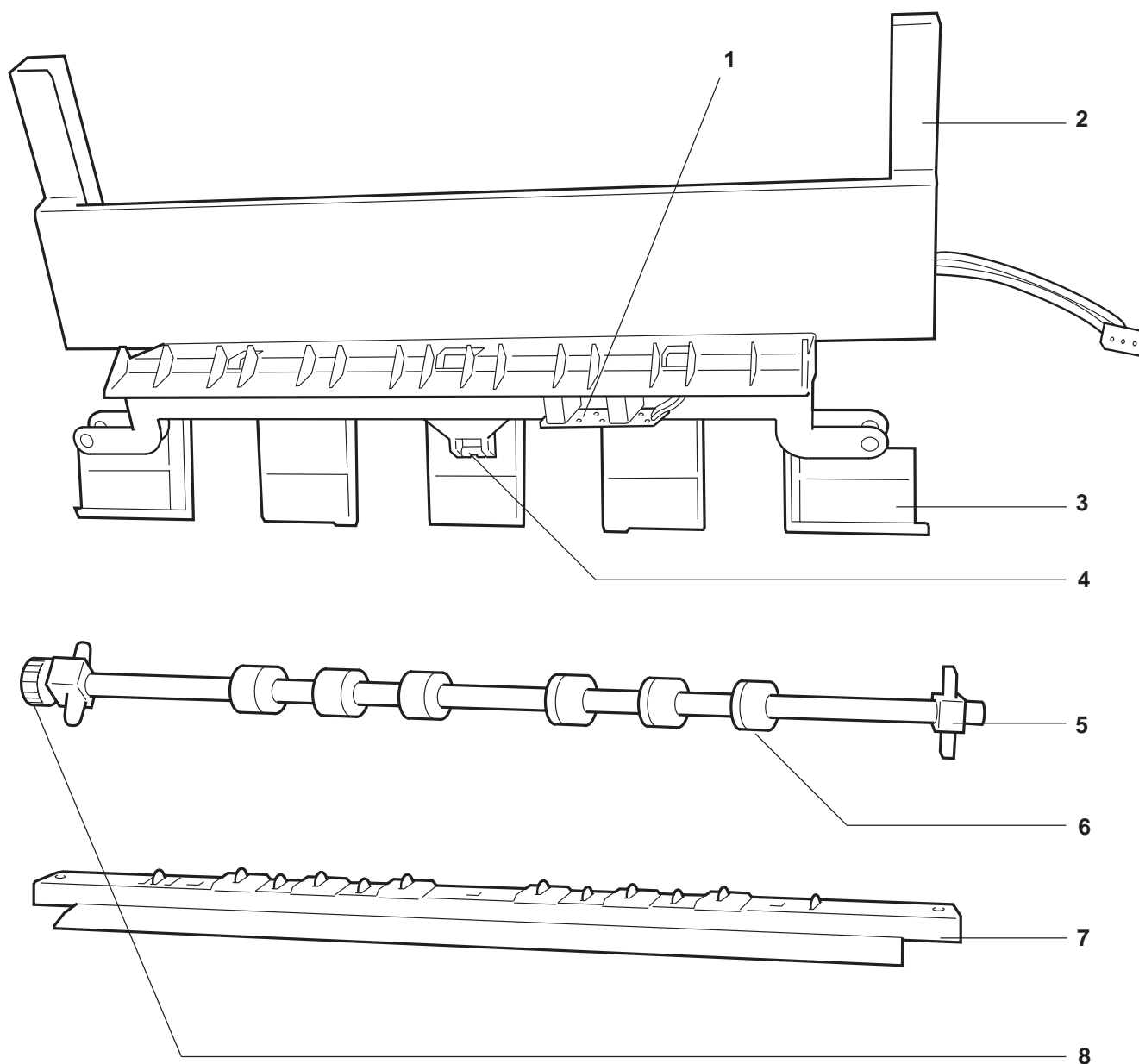

GR. RULLO TRASCINAMENTO (CASSETTO 1) FEED ROLLER ASSEMBLY (CASSETTE 1)

STUDIOJET 300

REF.	CODE	DESCRIZIONE	DESCRIPTION
1	290118 F	GUANCETTA SINISTRA	LEFT PAPER GUIDE
2	290120 D	TRAVERSA PREDISPOSIZIONE CARTA	PAPER SUPPORT SLEEPER
3	290117 W	GUANCETTA DESTRA	RIGHT PAPER GUIDE
4	290157 E	GRUPPO RULLO CENTRALE	CENTRAL ROLLER ASSEMBLY
5	290132 V	MOLLA PER LEVA SENSORE	SPRING FOR SENSOR LEVER
6	290137 S	LEVA SENSORE CARTA	PAPER SENSOR LEVER
7	290251 L	GRUPPO INTRODUTTORE FRONTALE	FRONT FEEDER ASSEMBLY

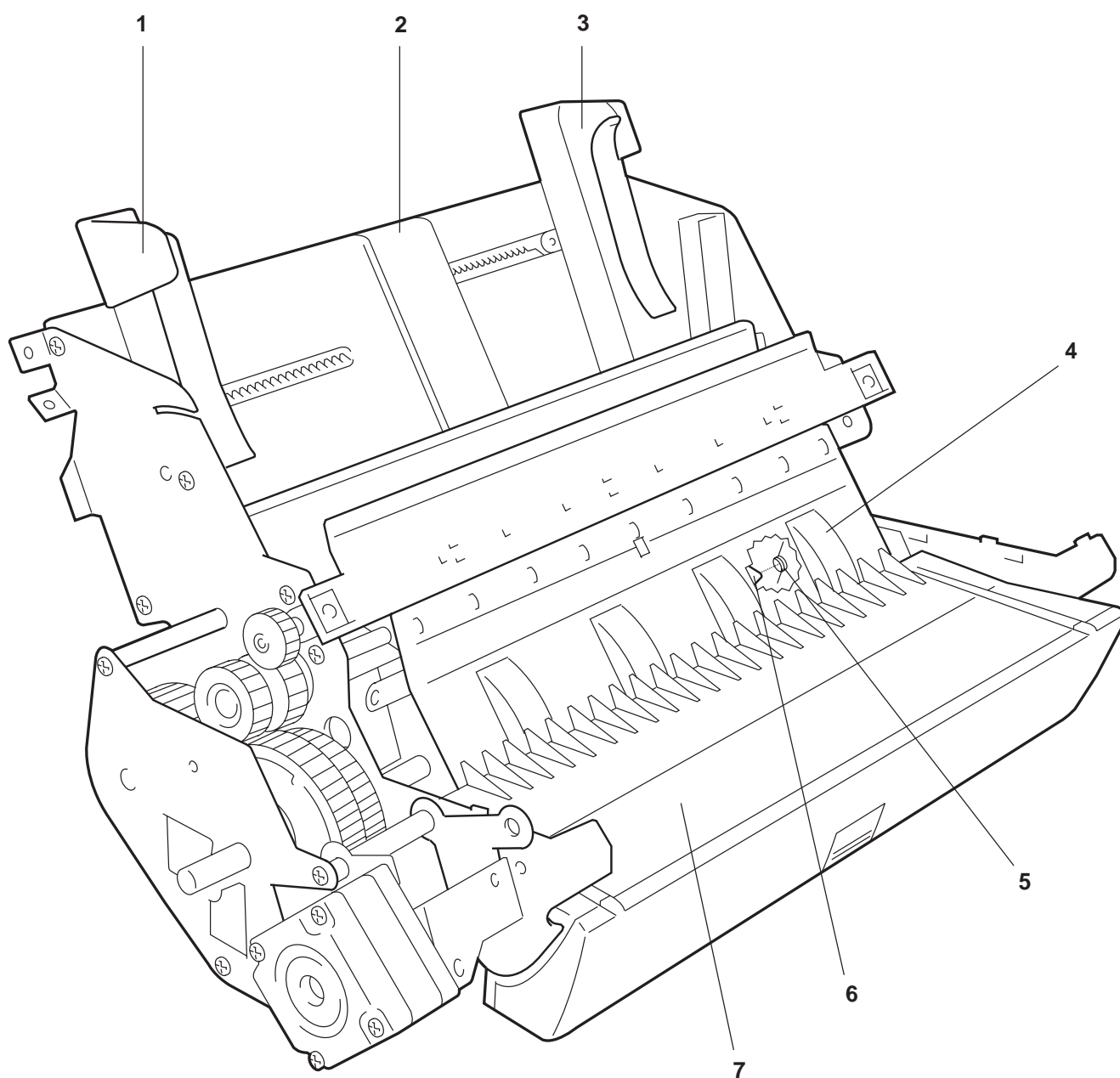

GR. TRASCINAMENTO CARTA (CASSETTO 1)
PAPER FEED ASSEMBLY (CASSETTE 1)

STUDIOJET 300

REF.	CODE	DESCRIZIONE	DESCRIPTION
1	290119 G	INGRANAGGIO	GEAR
2	290122 T	MOLLA FRIZIONE GUANCE	CLUTCH SPRING
3	290128 H	BARRA DI TORSIONE	TORSION BAR
4	290129 A	LEVA INTERNA COMANDO CASSETTO	CASSETTE COMMAND INTERNAL LEVER
5	290127 Y	LEVA ESTERNA COMANDO CASSETTO	CASSETTE COMMAND EXTERNAL LEVER
6	290186 U	MOLLA PER RULLINI	SPRING FOR ROLLERS
7	290148 M	MOLLA PER RULLINI RIFIUTO	SPRING FOR REFUSAL ROLLERS
8	290260 Z	GRUPPO RULLINI RIFIUTO	REFUSAL ROLLERS ASSEMBLY
9	290154 B	LEVA COMANDO SCARICO RULLINI	ROLLERS ESCAPE COMMAND LEVER

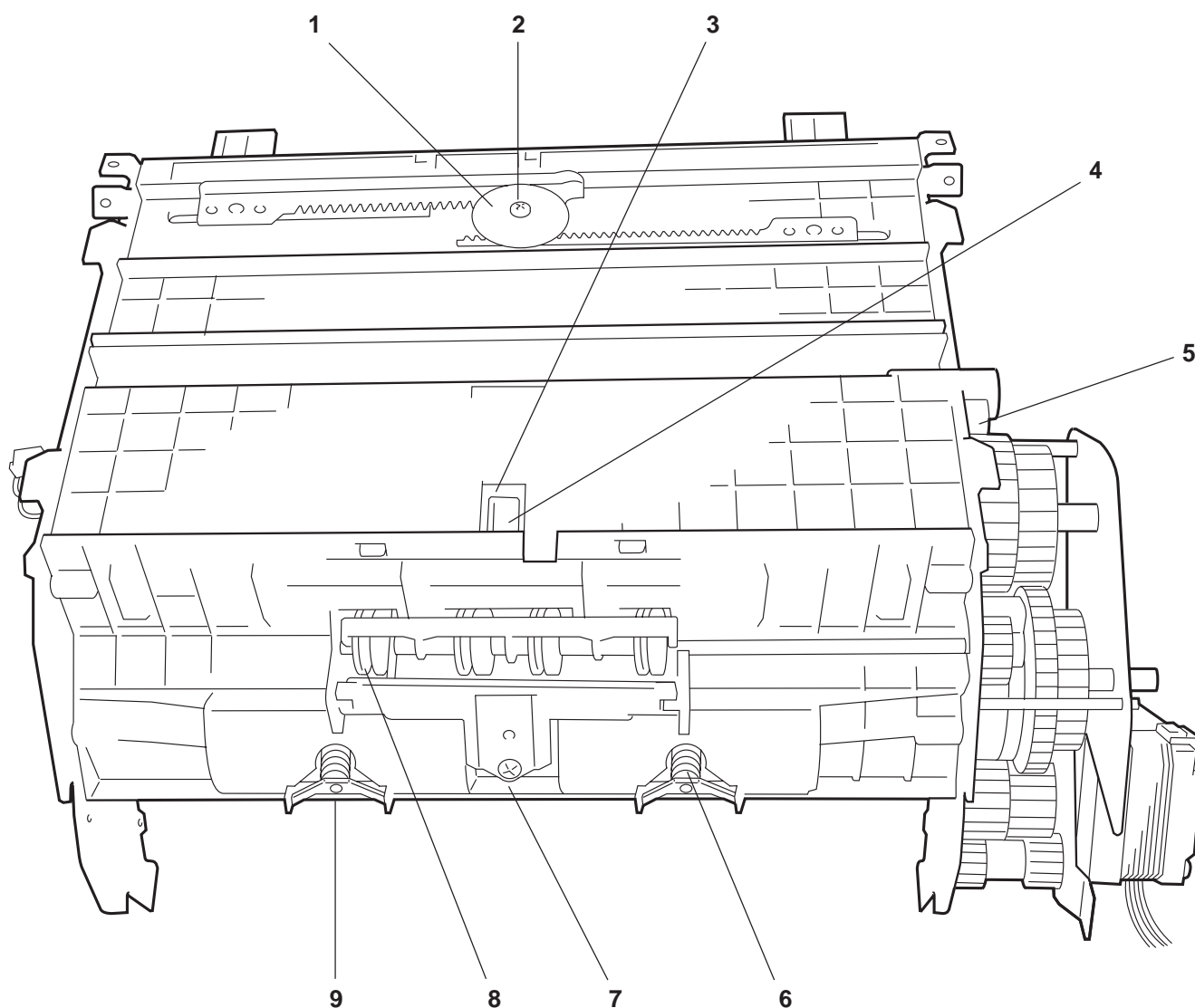

GRUPPO TRASCINAMENTO CARTA PAPER FEED ASSEMBLY

STUDIOJET 300

REF.	CODE	DESCRIZIONE	DESCRIPTION
1	290141 E	CUFFIA PER RULLINI	COWLING FOR ROLLERS
2	290178 K	SUPPORTO RULLINI INFERIORI	LOWER ROLLERS SUPPORT
3	290179 L	RULLINI CONTRASTO	CONTRAST ROLLERS
4	290149 N	INGRANAGGIO COMANDO RIFIUTO	REFUSAL COMMAND GEAR

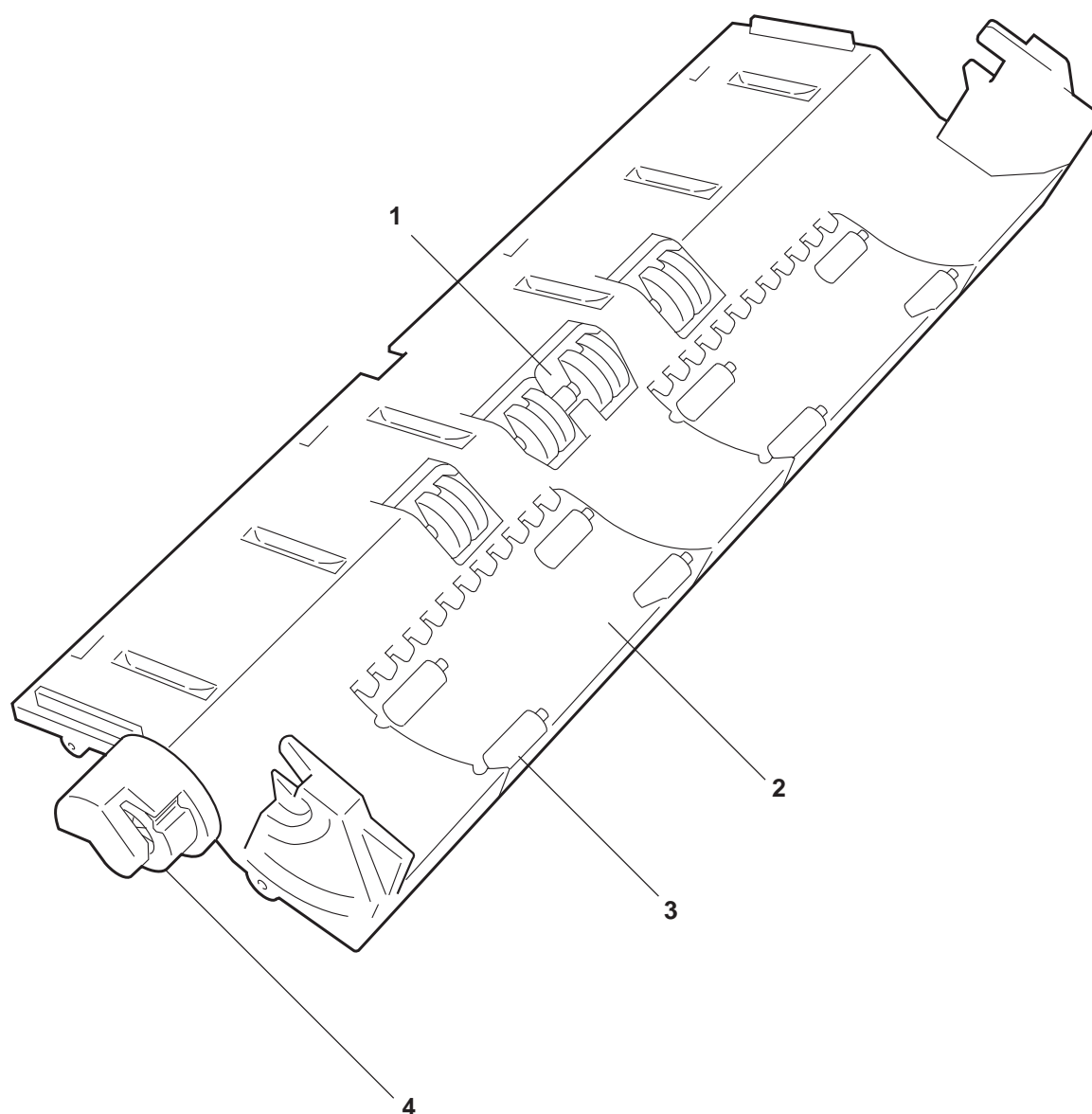

REF.	CODE	DESCRIZIONE	DESCRIPTION
1	290173 E	LEVA PER CONTROMARCIA RULLO	LEVER FOR ROLLER REVERSE MOTION
2	290192 S	MOLLA PER FRIZIONE CASSETTO	SPRING FOR CASSETTE CLUTCH
3	290193 T	INGRANAGGIO PREDISPOSIZIONE	ARRANGEMENT GEAR
4	290195 V	INGRANAGGIO COMANDO CASSETTO	CASSETTE COMMAND GEAR
5	290191 Z	STAFFA PORTAMOLLA	SPRING HOLDER ROD
6	945320 H	ANELLO ELASTICO	RING, E

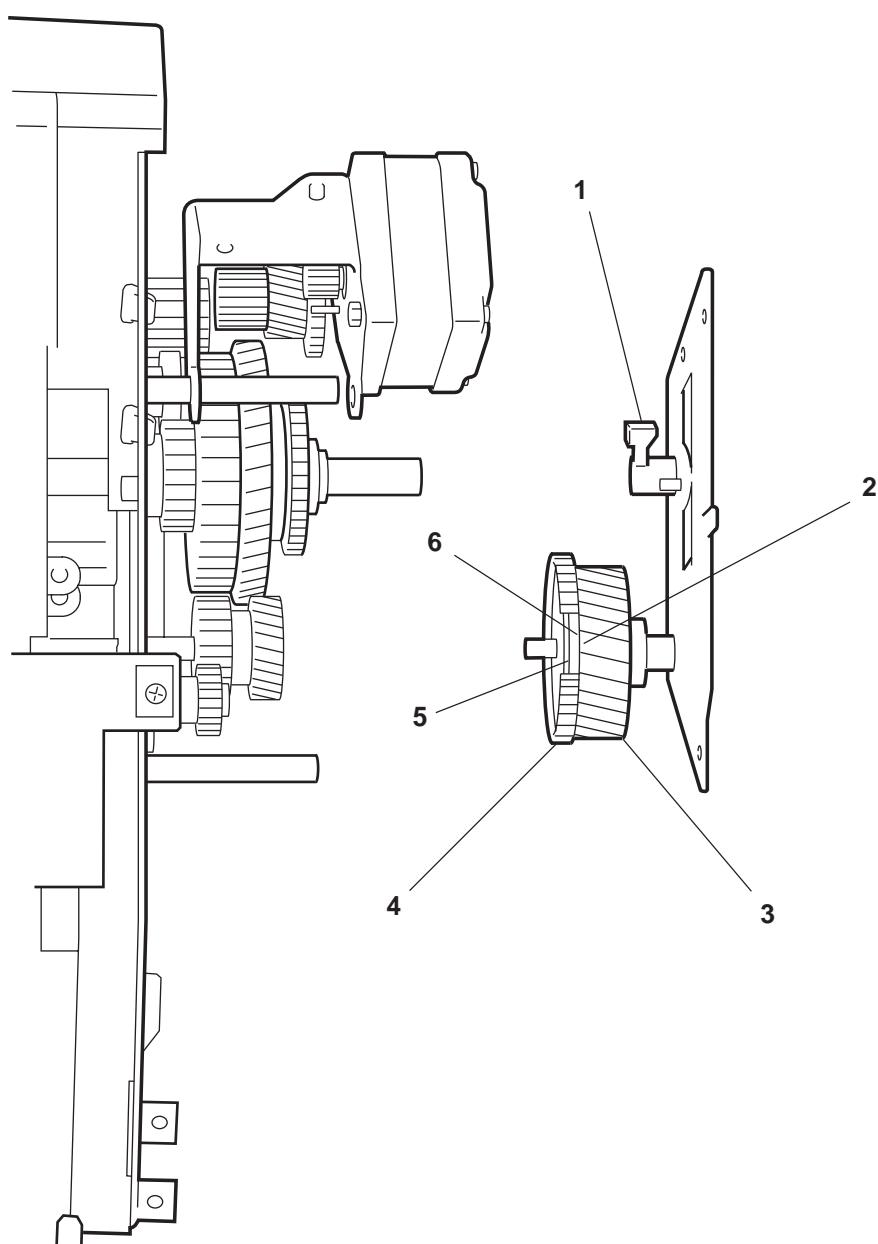

GRUPPO AVANZAMENTO CARTA PAPER ADVANCEMENT ASSEMBLY

STUDIOJET 300

REF.	CODE	DESCRIZIONE	DESCRIPTION
1	290110 B	INGRANAGGIO RINVIO INTERLINEA	LINE FEED RETURN GEAR
2	290107 D	GRUPPO MOTORE INTERLINEA	LINE FEED MOTOR ASSEMBLY
3	290172 D	FLANGIA CONTROMARCIA RULLO	ROLLER REVERSE MOTION FLANGE
4	290182 Y	MOLLA PER RULLINI	SPRING FOR ROLLERS
5	290076 G	INGRANAGGIO COMANDO ESPULSIONE	EJECTOR COMMAND GEAR
6	290106 C	GR. COMANDO INTERLINEA	LINE FEED COMMAND ASSEMBLY

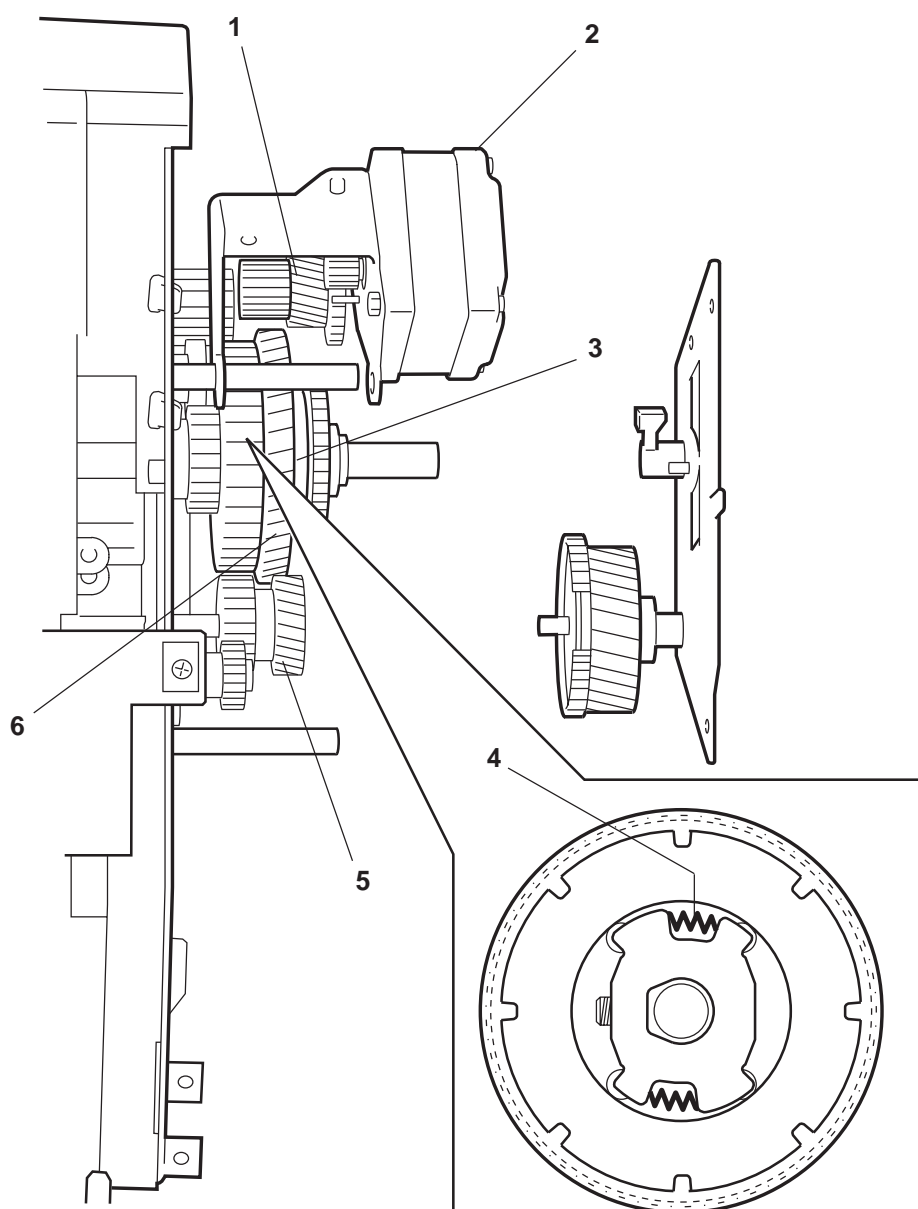

INDICE GENERALE DEI CODICI

GENERAL CODEX INDEX

INDICE GENERALE DEI CODICI **GENERAL CODES INDEX**

STUDIOJET 300

CODICE CODE	PAGINA PAGE	CODICE CODE	PAGINA PAGE	CODICE CODE	PAGINA PAGE
204070L	7	290227C	13		
204071H	7	290235C	13		
204106A	8	290236D	13		
204125U	8	290239Q	13		
204126V	10	290241J	13		
204128F	11	290242K	15		
204129G	11	290245N	13		
204130D	11	290249S	15		
204131S	12	290251L	18		
204132T	10	290252M	15		
204133U	10	290260Z	19		
204140P	9	290268V	13		
204148K	9	290283D	13		
204170M	4	290305K	4		
204171A	3	290311G	4		
204172B	3	290318P	4		
204172B	6	290358X	4		
280634A	9	290474C	13		
290070N	17	290480F	16		
290076G	22	290481U	17		
290096V	17	290497U	6		
290098F	17	290498D	6		
290099G	17	290511Z	6		
290106C	22	290626C	3		
290107D	22	290628N	7		
290110B	22	290635D	9		
290117W	18	290636E	7		
290118F	18	290637F	7		
290119G	19	290638Q	5		
290120D	18	290639R	7		
290122T	19	290640W	6		
290125W	17	290641K	3		
290126X	17	290706M	13		
290127Y	19	290740S	3		
290128H	19	290741P	3		
290129A	19	945320H	21		
290132V	18				
290136Z	17				
290137S	18				
290141E	20				
290148M	19				
290149N	20				
290154B	19				
290157E	18				
290172D	22				
290173E	21				
290178K	20				
290179L	20				
290182Y	22				
290186U	19				
290191Z	21				
290192S	21				
290193T	21				
290195V	21				
290211C	14				
290212D	13				
290214F	13				
290220R	15				
290225A	15				
290226B	15				

STATO DI AGGIORNAMENTO UPDATING STATUS

[illegible]